



BOERNE *Heights*



JULY 2018

VOLUME 2 ISSUE 3

Welcome TO BOERNE HEIGHTS

*A Newsletter for the
Boerne Heights Community*

Boerne Heights is a quarterly newsletter mailed to all Boerne Heights residents. Each newsletter will be filled with valuable information about the community, local area activities, school information, and more.

If you are involved with a school group, play group, scouts, sports team, social group, etc., and would like to submit an article for the newsletter, you can do so online at www.PEELinc.com. Personal news (announcements, accolades/ honors/ celebrations, etc.) are also welcome as long as they are from area residents.

GO GREEN! Subscribe via Peelinc.com to have an email sent to you with a link to a PDF of the newsletter, or have an email sent to you instead of having a newsletter mailed to you!



DEAR RESIDENTS,

Greetings from your newly elected District 5 City Councilman, Tim Handren. In the spirit of transparency, I'll be sending out periodic newsletters about the bigger items that are in flight on City Council. There are lots of places to get information, so this will be an attempt to help you stay tuned to what's coming.

One big item I have received many questions about is the Kendall County Gateway Study. To provide a little background, about 2 years ago there was a joint resolution from both Boerne City Council and the Kendall County Commissioners Court that asked Texas Department of Transportation (TxDOT) to perform a feasibility study on ways to solve the heavy traffic flowing into Boerne on Hwy 46, among others roads. TxDOT has spent the last 2 years performing traffic flow analysis and they have also had meetings asking for public input on ideas that may help alleviate traffic coming through Boerne. That study is coming to an end and the final report will be provided to Kendall County Commissioners this coming month. Shortly after that, they will present that report to City Council. The recommendations can be found at this website: www.txdot.gov/inside-txdot/projects/studies/san-antonio/kendall-gateway-study.html. The recommendation from TxDOT is a loop around Boerne, which you can see on the website above under the link: Recommended Concepts Map. The big question that comes after this study is, "What happens now?" At the moment, I can tell you that there is no plan of attack. There will be many issues associated with the recommended route, but the biggest issue regarding any plans will be funding. Since the entire recommended solution lies completely in Kendall County, and out of the city limits of Boerne, funding will be very challenging. Obviously for those property owners in the recommended route of the new road, there will necessarily be concerns of a more personal nature. I have asked the Mayor to consider putting me on any task force that is given the assignment to develop a plan. From what I have discussed with both city and county officials, nothing will happen soon. In fact, it will likely be years before anything begins, but the most congested areas are on the East side of Boerne, mostly from Hwy 46. More to come on this topic as I receive additional information and details.

The second big item is the Boerne 10 Year Master Plan, 2018-2028.

(Continued on Page 2)

BOERNE HEIGHTS

DIRECTOR OF COMMUNITY MANAGEMENT

JENEE LEWIS
Jenee.Lewis@fsresidential.com

(Continued from Cover)

The first draft of the plan will be available in July on the city's website. At that time, the public will have an opportunity to comment on the items in the plan and provide feedback to the city staff. This project has been in flight for quite some time now and I am looking forward to seeing the draft, too. Of note will be the conceptual City Land Use map, which will show current and future areas of residences, businesses and nature. From this new Master Plan, many existing city ordinances will need to be revised. I have already had discussions with city staff about revising several ordinances and there has been complete openness to the ideas discussed. One example is to update the sign ordinance. Presently, there is a sign committee that can approve height variances from a maximum of 45 feet to 75 feet, with no City Council governance. That portion of the ordinance has not been revised in many years, but we should be updating it very soon.

These are just a glimpse into some of the things going on in our great city, and I will do my best to share information as much as possible. I will also be posting and updating information on Facebook, so please follow me at: www.facebook.com/tim.handren.district.5. Also, my email address is: thandren@boerne-tx.gov should you have specific questions or comments. Thank you for your time.



CONCERNS OR QUESTIONS?

Feel free to contact the Board of Directors at boerneheightsboard@yahoo.com if you have any questions or concerns. Elected board members are: Lynnese Graves, Bobby Ryan and Crystal Pena.

NOT AVAILABLE ONLINE

DID YOU SAY FREE?

**YES! YOUR NEWSLETTER IS
PROVIDED 100% FREE OF CHARGE**

and is made possible by the advertisers within. Please frequent their businesses and let them know where you saw their advertisement. While there, be sure to say "Thanks!"

www.PEELinc.com

PEEL, INC.
community newsletters



**RESIDENTS, PLEASE
CONTINUE TO MONITOR
CITY OF BOERNE'S WEBSITE,
[HTTP://WWW.CI.BOERNE.
TX.US/](http://www.ci.boerne.tx.us/) FOR WATER
RESTRICTIONS.**

Current Water Conservation Stage

City of Boerne Water Conservation

Stage 1 Mandatory Compliance

Landscape watering with sprinklers or
irrigation systems allowed only

7:00 pm – 11:00 am

2 days per week according to street
address (1 weekday & 1 weekend day)

Hand watering with hose or bucket
allowed anytime.



**designs for
new construction, additions
& remodeling**

john travis / architect

26026 Serenity Ridge, San Antonio, TX 78258
ph: (210) 481-3022 cell: (210) 683-3834
jtravis2@satx.rr.com



HOME TEAM
OF AMERICA



KELLIE GUERRA
REALTOR

[KELLIE@KELLIEGUERRA.COM](mailto:kellie@kellieguerra.com)
210.501.9411

We're the Spay/Neuter Experts!



AFFORDABLE SPAY & NEUTER SERVICES
924 N Main in Boerne, TX

**Together, we can minimize the overpopulation
of dogs and cats in the greater Hill Country area,
preventing unwanted litters and euthanasia, and
reducing the stress on area shelters!**

**Our affordable spay/neuter packages include:
rabies vaccination, booster vaccination, microchip,
and pain medicine injection.
Call our appointment desk to inquire: 830-249-2341**

**While you're in Boerne, don't forget to check out our
awesome Thrift Store,
115 W Bandera next to Sonic!
Hours: Tues, Thurs-Sat 10am-3pm.
Proceeds benefit our spay/neuter clinic!**

**Hill Country Animal League is a 501(c)3 nonprofit. Go to www.hcaltx.org
to learn more or to donate today!**

CROSSWORD PUZZLE

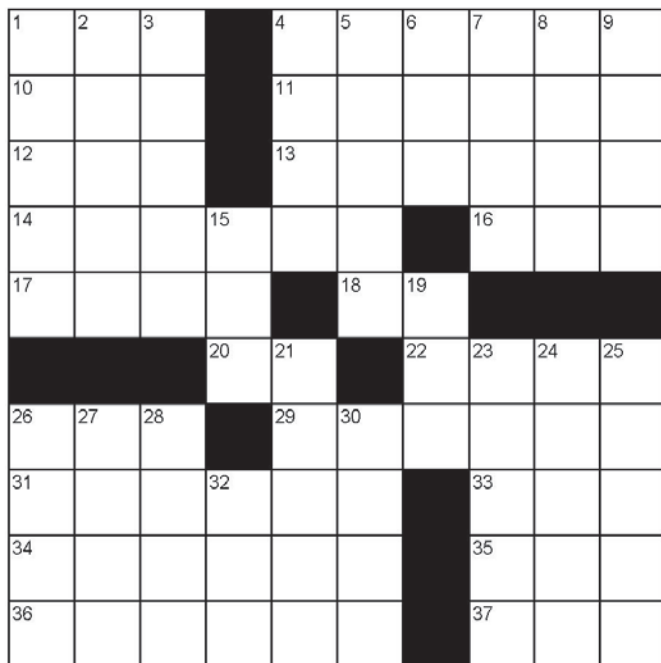

ACROSS

1. Food and Agriculture Organization (abbr.)
4. Scales
10. Hovercraft
11. Type of phone
12. Regret
13. State capital
14. Indian weapons
16. Part of a min.
17. Information
18. Hey!
20. Fire department (abbr.)
22. Captain (abbr.)
26. Pouch
29. Woman in the Old Testament
31. Absence of values
33. Time period
34. National capital
35. Official canine registry (abbr.)
36. Pseudonym
37. Change hue

DOWN

1. Unit of electric capacitance
2. Sporty car brand
3. Unconcealed
4. Animal stomach
5. Crummy
6. Possessive pronoun
7. Welcome rugs
8. Cheese
9. In __ (together)
15. Clod
19. Fall mo.
21. Divinity
23. Leading
24. Jaunty
25. Draw over
26. Baby's "ball"
27. After awhile
28. __ girl
30. Sew together
32. First day of wk.

View answers online at www.peelinc.com

© 2006. Feature Exchange

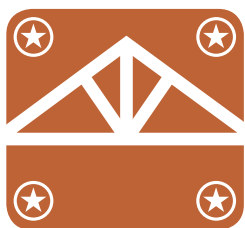

SHAW

CONSTRUCTION SERVICES

Serving Boerne, Fair Oaks, &
Northwest San Antonio

CUSTOM HOMES & GARAGES
CUSTOM ADDITIONS
KITCHEN & BATH
CONCRETE DRIVEWAYS
BARNDOMINIUMS
PAINTING

361.549.7485

ryankscs@gmail.com



SHAWCONSTRUCTIONSERVICES.COM

MUD DAUBERS

TEXAS A&M AGRI LIFE EXTENSION

SPIDER MITES

Mud daubers are a great wasp to have around. They are solitary, generally docile, and can help to reduce various bugs in the landscape. Mud dauber wasps are $\frac{3}{4}$ - 1" in size and come in a variety of colors. They have a very thin, thread-like waist.

Mud daubers create a mud structure that they provision with insects and/or spiders; they lay an egg on each prey item within a cell in the nest, and then seal the nest off. When larvae hatch from eggs, they eat the items provisioned for them, pupate, and then emerge as adults to begin the process over.

Management is not usually needed for mud daubers as they do not guard their nest like other wasps. While they are capable of stinging, they are not considered to be aggressive. If you do not like the look of the mud nests, you can remove them with a putty knife.



It's hot. It's dry. It's time for spider mites. Spider mites are very small to microscopic in size and depending on how good your eyesight is, you may not be able to see them without a good hand lens or microscope.

While spider mites are not insects- they are arachnids and more closely related to spiders than insects- they are pests in the landscape. Most spider mites produce a webbing around their colony. It starts on the underside of leaves and will expand out as the population increases.

Feeding can cause leaves to discolor, creating a speckled appearance on foliage. With severe infestations, leaves discolor to a silver or bronze color which may result in leaves dropping from the plant. While mites feed on the underside of leaves, damage is more apparent on the tops.

Spider mites lay their eggs along the leaf vein during the growing season. Eggs are round and large in size when compared to adult mites. Some species of spider mites peak during warmer months of the year while others become more active in the cooler months of the year. The mites are able to develop more quickly when temperatures are warmer, with some spider mites going from egg to adult in less than 1 week. Spider mites thrive in dry conditions while their natural enemies require more humid conditions. Dry conditions allow spider mite populations to grow with little predation or parasitism that would help to keep the population at an acceptable level.

There are many predatory arthropods that feed on spider mites. Some of these include predatory mites, spider mite destroyers (a type of ladybug), minute pirate bugs, big-eyed bugs, and predatory thrips. Proper watering of plants may help to reduce spider mite outbreaks as it can reduce stress brought on by drought. Using strong jets of water directed on plants can also help to dislodge spider mites. Miticides or acaricides can be used to manage spider mite outbreaks. Look for active ingredients such as horticultural oils (watch temperature when you use oils), insecticidal soaps, spinosad, abamectin, bifenthrin, dimethoate, or acephate.

For more information or help with identification, contact Wizzie Brown, Texas AgriLife Extension Service Program Specialist at 512.854.9600. Check out my blog at www.urban-ipm.blogspot.com This work is supported by Crops Protection and Pest Management Competitive Grants Program [grant no. 2017-70006-27188 / project accession no. 1013905] from the USDA National Institute of Food and Agriculture. The information given herein is for educational purposes only. Reference to commercial products or trade names is made with the understanding that no discrimination is intended and no endorsement by Texas A&M AgriLife Extension Service or the Texas A&M AgriLife Research is implied. The Texas A&M AgriLife Extension Service provides equal access in its programs, activities, education and employment, without regard to race, color, sex, religion, national origin, disability, age, genetic information, veteran status, sexual orientation or gender identity.

BOERNE HEIGHTS

At no time will any source be allowed to use the Boerne Heights Community Newsletter contents, or loan said contents, to others in anyway, shape or form, nor in any media, website, print, film, e-mail, electrostatic copy, fax, or etc. for the purpose of solicitation, commercial use, or any use for profit, political campaigns, or other self amplification, under penalty of law without written or expressed permission from the Boerne Heights Homeowner's Association and Peel, Inc. The information in the newsletter is exclusively for the private use of Boerne Heights residents only.

DISCLAIMER: Articles and ads in this newsletter express the opinions of their authors and do not necessarily reflect the opinions of Peel, Inc. or its employees. Peel, Inc. is not responsible for the accuracy of any facts stated in articles submitted by others. The publisher also assumes no responsibility for the advertising content with this publication. All warranties and representations made in the advertising content are solely that of the advertiser and any such claims regarding its content should be taken up with the advertiser.

* The publisher assumes no liability with regard to its advertisers for misprints or failure to place advertising in this publication except for the actual cost of such advertising.

* Although every effort is taken to avoid mistakes and/or misprints, the publisher assumes no responsibility for any errors of information or typographical mistakes, except as limited to the cost of advertising as stated above or in the case of misinformation, a printed retraction/correction.

* Under no circumstances shall the publisher be held liable for incidental or consequential damages, inconvenience, loss of business or services, or any other liabilities from failure to publish, or from failure to publish in a timely manner, except as limited to liabilities stated above.



Coffee-Chocolate Chip Cookies

INGREDIENTS

1 ½ cups flour
¼ tsp baking soda
¾ cup butter softened
¾ cup sugar
½ cup brown sugar
3 tbsp cool strong brewed coffee
1 egg
1 tsp vanilla
2 pkgs (8 ozs.) semi sweet chocolate, chopped
1 ½ cups chopped walnuts

DIRECTIONS

Heat oven to 325 degrees.
Combine flour and baking soda.
Beat sugars & butter until light & fluffy.
Blend in coffee, egg & vanilla.
Gradually beat in flour mixture until well blended.
Stir in chopped nuts & chocolate. Refrigerate 30 mins.
Roll dough into 60 x 1" balls, place on cookie sheet 2" apart.
Bake 10-12 mins. Enjoy!



ADVERTISE
YOUR BUSINESS
TO YOUR
NEIGHBORS

support your community newsletter

Nichole Taylor

ntaylor@peelinc.com • 512-263-9181
Sales Representative



ATTENTION KIDS: SEND US YOUR MASTERPIECE!

Color the drawing below and mail the finished artwork to us at:

Peel, Inc. - Kids Club

308 Meadowlark St. Lakeway, TX 78734-4717

We will select the top few and post their artwork on our website at www.peelinc.com/index.php/kids-club

DUE: July 31st, 2018

Be sure to include the following so we can let you know!

Name (first name, last initial): _____ Age: _____

**CELEBRATE
INDEPENDENCE
DAY ON
JULY 4TH!**

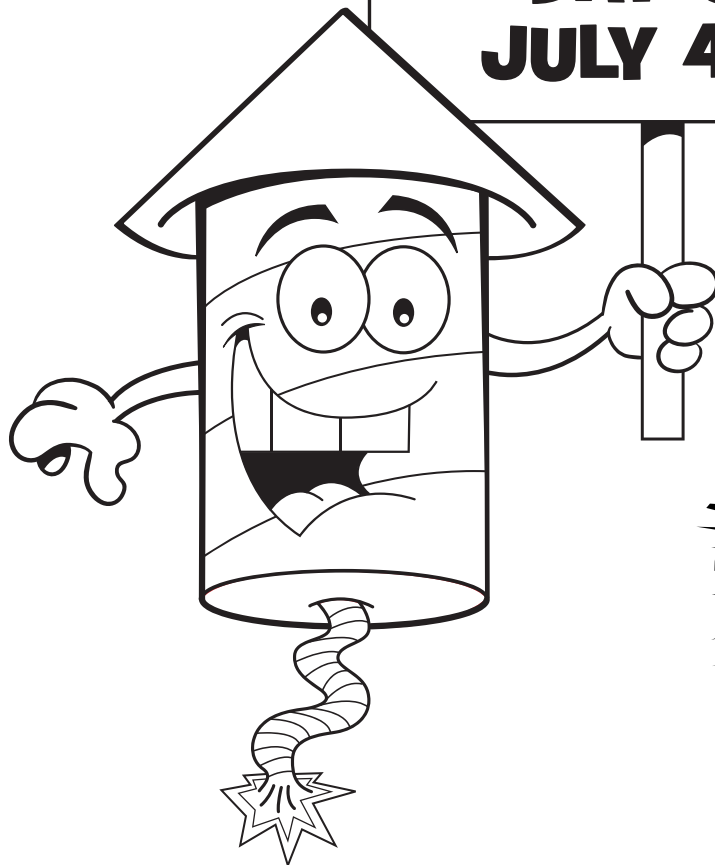

BHT



PEEL, INC.

308 Meadowlark St. South
Lakeway, TX 78734

PRSR STD
U.S. POSTAGE
PAID
PEEL, INC.

BHT

Advertising Exposure Tailored Just For Realtors



Advertising Helps Sell Your Listings & Promote Your Real Estate Company.

Contact A Sales Representative Today
to Make This Space Work For You!

1-888-687-6444 or www.peelinc.com



PEEL, INC.
community newsletters